

# High impact tank cleaning machine

## MeshClean

### Series 5T2/5T3



#### Features:

- High efficiency thanks to especially powerful solid jet nozzles
- Also suitable for smaller tanks with stubborn soiling
- Active self-cleaning through special nozzle geometry
- Particularly low-maintenance



**ATEX version  
on request**



Series 5T2/5T3

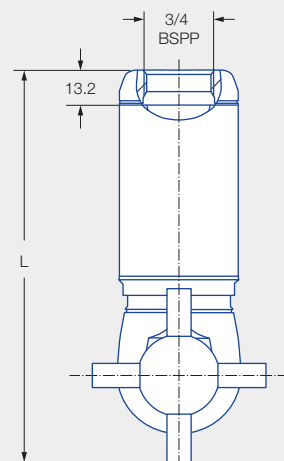

Female thread

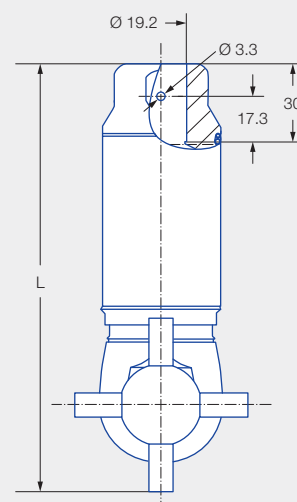

Dimensions of slip-on connection  
according to ASME-BPE (OD tube)

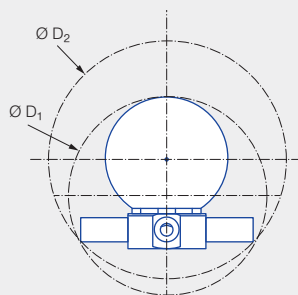

Insertion diameter  $D_1$  and  
interference circle diameter  $D_2$   
of the threaded connection

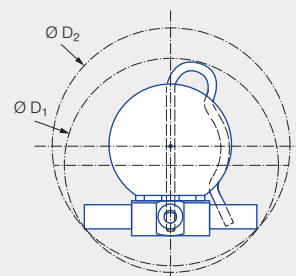

Insertion diameter  $D_1$  and  
interference circle diameter  $D_2$   
of the slip-on connection

 Max. tank diameter [m]	0			3			6			9			12			15			18			21			24			27		
----------------------------------------------------------------------------------------------------------	---	--	--	---	--	--	---	--	--	---	--	--	----	--	--	----	--	--	----	--	--	----	--	--	----	--	--	----	--	--



**Cleaning efficiency class**  
5



**Max. temperature**  
150 °C



**Installation**  
Operation in every installation position



**Bearing**  
Ball bearing



**Material**  
Stainless steel 316L,  
PTFE, PEEK,  
EPDM or FKM



**Recommended operating pressure**  
5 bar



**Filtration**  
Line strainer with a mesh  
size of 0.2 mm/80 mesh



**Rotation monitoring**  
Sensor compatible,  
for information:  
See Page 229



**Adapter**  
3/4 BSPP is compatible  
with HygienicFit

[www.lechler.com/de-en/medialibrary/videos-general-industry](http://www.lechler.com/de-en/medialibrary/videos-general-industry)  
Or scan the QR code.

**Function video**

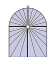

Spray angle	Ordering no.						Narrowest free cross section Ø [mm]	Number, Ø Nozzles [mm]	V̇ water [l/min]						Dimensions [mm]						Max. tank diameter [m]	
	Type	Connection							p [bar] (p <sub>max</sub> = 15 bar)						Female thread			Slip-on connection				
		3/4 BSPP		3/4" slip-on connection																		
		EPDM	FKM	EPDM	FKM	2.0			3.0	5.0	10.0	at 40 psi [US gal/min]	L	Ø D <sub>1</sub>	Ø D <sub>2</sub>	L	Ø D <sub>1</sub>	Ø D <sub>2</sub>				
	5T2.849.1Y	AL	22	TF07	31	1.75	4 × 1.75	13	15	20	28	4	142	68	82	157	77	82	11.5			
	5T2.969.1Y	AL	22	TF07	31	2.70	4 × 2.70	25	31	40	57	8	142	68	82	157	77	82	12.0			
	5T3.029.1Y	AL	22	TF07	31	3.20	4 × 3.20	35	43	55	78	11	142	68	82	157	77	82	12.5			
	5T3.089.1Y	AL	22	TF07	31	4.00	4 × 4.00	50	61	79	112	16	148	74	91	163	82	91	13.0			

The maximum tank diameter applies to the recommended operating pressure and is meant as a recommendation only.  
The cleaning result is also affected by the type of soiling.

Compressed air should be used for dry blowing for a short time only. Operation above the recommended operating pressure has a negative impact on the cleaning result and wear.

Ordering    Type    +    Code    =    Ordering no.  
example:    5T2.849.1Y    +    AL    =    5T2.849.1Y.AL

